



# Undergraduate prospectus

**Dentistry** Entry 2012



# Contents

King's is...	1
King's College London Dental Institute	2
Welcome from the Dean	3
Dentistry at King's & Admissions to King's	5
Location	6
Accommodation & Student Services	10
Funding	13
When I'm not studying	15
Graduation & beyond	16
Dental programmes	21
Selection procedure	26
General admissions information	29
Contacts	32

King's Health Partners Academic Health Sciences Centre (AHSC) is a pioneering collaboration between King's College London and Guy's and St Thomas', King's College Hospital and the South London and Maudsley NHS Foundation Trusts.

King's Health Partners is one of only five AHSCs in the UK and brings together an unrivalled range and depth of clinical and research expertise, spanning both physical and mental health. Our combined strengths will drive improvements in care for patients, allowing them to benefit from breakthroughs in medical science and receive leading-edge treatment at the earliest possible opportunity.

For more information, visit [www.kingshealthpartners.org](http://www.kingshealthpartners.org)

# King's is...

*King's is ranked in the top 25 universities worldwide  
QS World University Rankings, 2010*

*The fourth-oldest university institution in England  
with a long tradition of excellence*

*A multi-faculty institution, offering high-quality  
research and teaching across the sciences, medicine,  
dentistry, humanities, law and social sciences*

*Europe's largest centre for medical and professional  
healthcare education, and the only university to host  
six Medical Research Council centres: a quarter  
of the total in the UK*

*World-leading, with 91 per cent of research activity  
entered in the 2008 Research Assessment Exercise for  
British universities being internationally recognised.*

*Rated 'excellent' for students' educational experience by  
the Quality Assurance Agency*

*Right at the heart of London, King's is London's most  
central university with four campuses along the River  
Thames attracting major speakers, visitors and events*



King's was chosen as the *Sunday Times* University of the Year 2010-11. This accolade reflects all-round excellence, including student satisfaction, quality of research, the opinions of fellow-academics, the qualifications held by incoming students, degree results achieved, student/staff ratios, dropout rates and graduate employment levels.



## *King's College London Dental Institute*

---

*has confirmed its position as the most influential centre of excellence for oral and dental research in the UK, following the 2008 Research Assessment Exercise*

---

*is the largest dental school in the UK offering three entry routes to study dentistry and graduates over 160 dentists a year*

---

*offers students state-of-the-art clinical and technical facilities*

---

*offers an evidence-based, research-led degree programme with a high level of clinical experience in all areas particularly related to the future dentist*

---

*works in partnership with the world famous hospitals Guy's, King's College and St Thomas' in training tomorrow's dentists*

---

*offers the opportunity to choose to intercalate a BSc degree*

---

**King's top Guardian University Guide for dentistry**

King's College London Dental Institute was ranked first for undergraduate dental studies in the UK in the *Guardian University Guide 2012* league tables with a score of 100/100.

## *Welcome from the Dean*



King's College London Dental Institute is a dynamic, top ranking dental clinical academic centre forming an integral element of King's College London – one of the world's top 25 universities. The Institute's world renowned dental education programmes are provided in a research rich environment. The Institute's two dental hospitals and associated clinics, which together with the Institute form the Dental Clinical Academic Group of King's Health Partners, provide a full range of clinical services to a large, diverse population of patients.

Learning and teaching in the Institute is of the highest quality. The various programmes of instruction are based on a blended approach to dental education, with different methods being used according to specific requirements in different subject areas, and to assist students in realising their full potential in their university studies. Special attention is paid to professionalism, assessment and feedback and student support, as part of maximising the student experience.

Clinical instruction takes place in modern, high specification clinical facilities in which there is a strong emphasis on the dental team approach to comprehensive patient care. In addition to essential skills and competencies, students receive instruction in advanced techniques, including implant dentistry, and have an opportunity to see the provision of highly specialised, complex treatment provided by the Institute's uniquely large group of world authorities and opinion leaders in different aspects of orofacial healthcare provision. Students of the Institute have an opportunity to gain experience in different clinical environments, including placement in the state-of-the-art Dental Academy which the Institute developed in partnership with the University of Portsmouth. In addition, students are encouraged to participate in overseas electives before commencing the final year of their studies. Most electives are generously supported by special funds and alumni of the Institute who span the world.

With many of the graduates of the Institute going on to take higher clinical qualifications and postgraduate degrees, the Institute places special emphasis on its students being best placed to take advantage of the many exciting career opportunities in dentistry. King's College London Dental Institute is proud to see so many of its graduates go on to be important contributors to the further development and advancement of dentistry.

**Professor Nairn H F Wilson CBE FRC**  
*Dean & Head of the Dental Institute*



## *Dentistry at King's*



The dental curriculum at King's has a number of potential entry-points, all leading to the degree Bachelor of Dental Surgery. The curriculum is designed to allow students access to clinical dentistry as early as possible, you will be assisting in the dental care of patients from early in Year 1 of all programmes. Basic sciences are delivered throughout the programme but concentrated in the first three years. The final two years of the programme are designed to put students onto clinics as much as absolutely possible. Encouragement is given to experience work outside the confines of the Dental Institute in the intercalated BSc programmes and in the elective studies undertaken in Year 5.

We believe this curriculum offers an optimal experience and prepares a student very effectively for Dental Foundation Training and future practice. Students are expected to take responsibility for their learning from day one and will be given full assistance to succeed with this. It is a tough programme and we are not apologising for making it so. But once you have passed the BDS degree from King's you will be well established for a career in whatever aspect of dentistry you wish to pursue. We want graduates to be able to undertake careers in clinical dentistry, general practice, specialist practice, research, academia, and the programme is designed to allow the full scope of subjects to be developed by each student as they see appropriate.

A BDS degree from King's means you will have been well trained and well educated in dentistry, in its widest context.

**Dr Mark Woolford**  
*Director of Education*

## *Admissions to King's*



The likelihood is that you are reading this prospectus because you are serious about a career in dentistry. Obviously we hope you will consider King's; we passionately believe the Dental Institute is a match

for any school in the UK and as you read these pages you will be introduced to aspects of life at King's of which we are very proud. You will also find details regarding the application procedure and advice on how best to maximize your chances of gaining a place to study dentistry with us. Do come and visit us at one of our Open Days; absorb the atmosphere, speak to our students as they work in state-of-the-art clinical facilities and then wander around historic Southwark. Few university locations have as much to offer. In fact as we go to press, we are delighted to note that the Guardian University Guide 2012 has King's ranked first for dentistry in the UK.

We have broken with tradition with regard to the entry requirements at the Dental Institute. We no longer have a standard offer. Candidates successful at interview may receive an offer from AAA/A to BBB/C at A Level (or equivalent) depending on achieved or predicted academic grades, educational context, UKCAT score, personal statement and reference.

At King's we want the best students regardless of their background, but we know the best students always have choice. We sincerely hope that for you that choice will be King's. But whatever choice of school you make I wish you all the very best with your application and I do hope you realise your ambition to study dentistry.

Good luck.

**Dr Lyndon Cabot**  
*Director of Admissions*

# Location



## Living and studying in London

Living in London is a memorable experience. There is a wealth of cultural and academic resources on your doorstep, from world-famous museums, libraries and theatres and galleries, to specialised collections and societies. Studying in London is a major advantage in terms of access to resources to aid and enhance your studies and maximise your spare time. As a student, it can cost you less to enjoy London than at any other time of your life. With around 16 per cent of the UK total student population living in London, the capital is well geared up for students. Being a student in London also puts you where the interesting work is. A survey by The Royal Bank of Scotland proclaimed London as the most cost-effective place to study, due in part to the large number of opportunities to work.

## The campus locations

King's is the most central university in London. Four of its five campuses are within a single square mile beside the Thames between Westminster and London Bridge – Guy's Campus, St Thomas' Campus, Strand Campus and Waterloo Campus. There are easy transport links to the fifth campus – King's Denmark Hill Campus in south-east London. Students at King's are therefore able to maximise the benefits of being close to the capital's arts centres, museums, libraries, historical monuments and major public

institutions. Dental students will begin their studies based mainly at the Guy's Campus for the first two years of their degree programmes. After that dental students will study at the King's Denmark Hill, Guy's and St Thomas' campuses, and the University of Portsmouth Dental Academy. The areas around the hospital campuses are densely populated and multi-ethnic, and experience high levels of disease, thus providing dental students with the widest range of clinical experience possible in order to prepare them for their professional careers.

## Guy's Campus

The Guy's Campus is situated next to London Bridge station. Dental students study here alongside medical, physiotherapy and science students. The Campus is a mixture of traditional and new buildings built around a central park. New Hunt's House is a purpose-built centre for biomedical science teaching and research, housing two large lecture theatres, seminar rooms and laboratories, and the information centre with library and computing facilities. The Chantler Clinical Skills Centre, which is shared with medical and nursing students, has simulated wards and anatomical models on which students can learn and practise a wide range of technical skills, from venepuncture and suturing to resuscitation and examination of the eye and ear. The Dental Institute at Guy's occupies the top 13 floors of the Guy's

Hospital Tower. It includes five clinical floors where students undertake the treatment of patients. There are clinical skills facilities (for restorative dentistry and sedation and resuscitation training), as well as teaching classrooms and demonstration surgeries. Research, a major activity in the Institute, is centred on three floors of the Institute which is a recognised centre of international excellence.

## King's Denmark Hill Campus

The King's Denmark Hill Campus is situated in south-east London. The Dental Hospital has a full range of recently refurbished facilities for the clinical instruction of students. Next to the Dental Hospital is the busy Day Surgery Centre with provision for minor oral surgery procedures. Dental students also spend time in the Maurice Wohl Dental Centre. A new Operating Theatre block equipped with the latest technology for different forms of surgery, including Oral and

Maxillofacial Surgery and Paediatric Dentistry, has recently been opened. The complex incorporates ten operating suites, a recovery ward and an intensive care unit. The Accident & Emergency Department has recently been developed to create a major treatment area and an extensive new ward block. The Weston Education Centre has facilities including a major library, computing facilities and a clinical skills classroom.

## St Thomas' Campus

The St Thomas' Campus occupies a riverside site overlooking the Houses of Parliament. Accident & Emergency services for the Guy's and St Thomas' NHS Trust are concentrated on this site. A superbly equipped 14-surgery dental centre offers an excellent environment for final year dental students to develop their skills as they approach qualification.



## The University of Portsmouth Dental Academy

The University of Portsmouth Dental Academy is an exciting development in the overall delivery of the BDS curriculum. Final year students attend the Dental Academy to work in a primary care setting alongside dental hygiene, therapy and dental nursing students. The University of Portsmouth campus is based around the Guildhall and students stay in en-suite halls of residence just minutes away from Gunwharf Quays and the Spinnaker Tower.

The clinical facilities are state-of-the-art and are designed to allow students to develop effective working practices

to facilitate the transition into Foundation Training. The residential nature of this outreach placement encourages students to immerse themselves in clinical dentistry and learn how to work as leaders of the dental team.

In the Dental Academy, our students are taught by local general dental practitioners appointed jointly by King's College London Dental Institute and the University of Portsmouth. We feel that this provides our students with the rich mix of teachers appropriate for final year education.

# Location

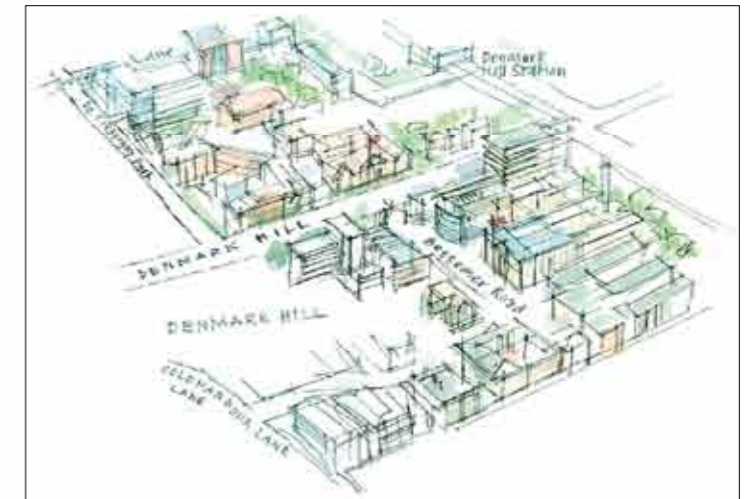
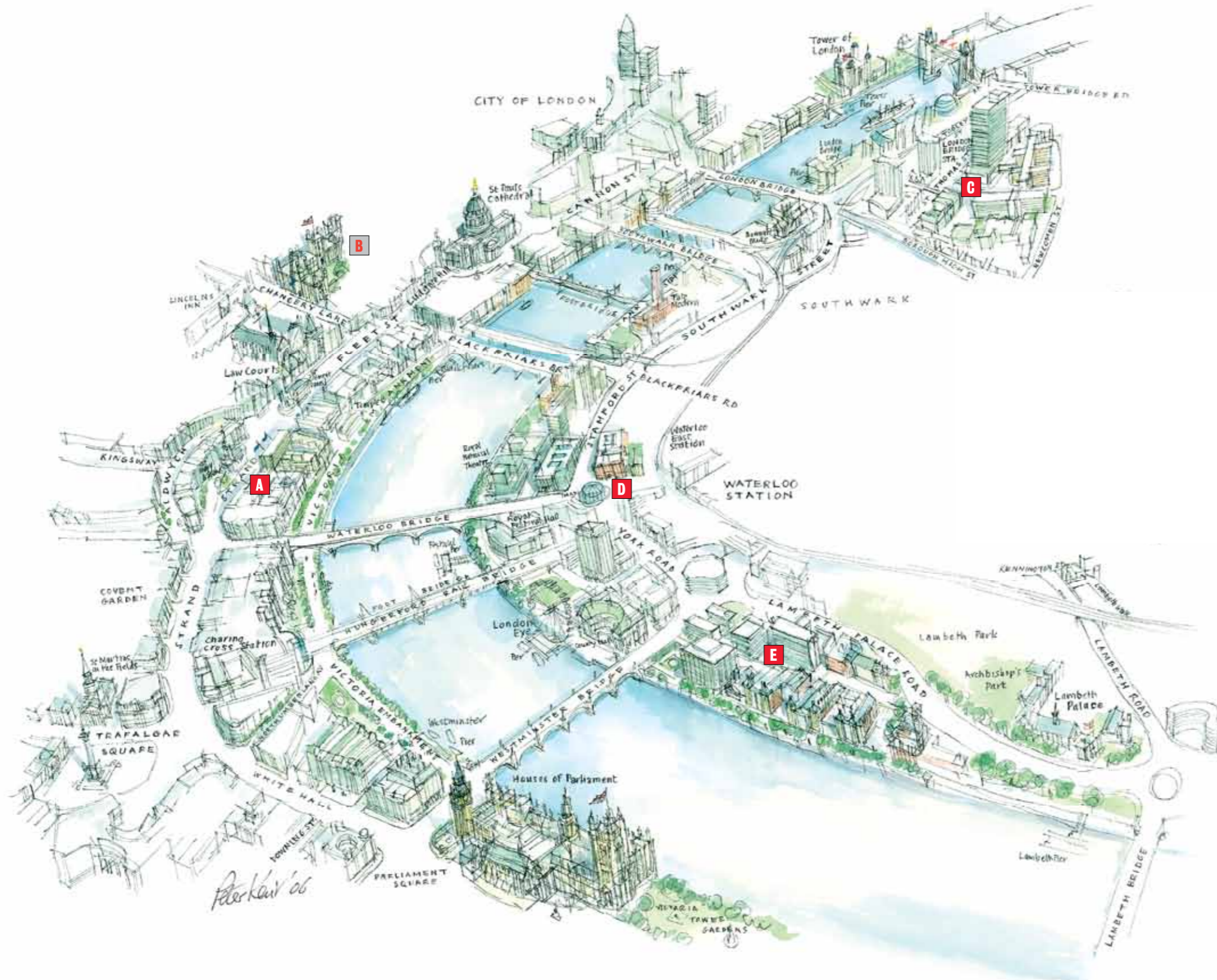

King's Denmark Hill Campus lies 2.3 miles due south of the Guy's Campus

- A** Strand Campus
- B** Maughan Library & Information Services Centre
- C** Guy's Campus
- D** Waterloo Campus
- E** St Thomas' Campus
- F** King's Denmark Hill Campus

# Accommodation & Student Services

## Student accommodation

The College Accommodation Services offer a range of accommodation to suit the varied needs of students. Most first-year undergraduates with a home address outside the M25 ring road will live in one of the College residences, Liberty House or in one of the University of London's Intercollegiate halls. Others may live at home, or in the private sector in shared houses or rented flats, and there is a good supply of properties that are affordable and reasonably central.

If you are a full-time undergraduate who will be entering the College for the first time on a course of two or more years, you are guaranteed the offer of a place in either a College, or an Intercollegiate or a nominated residence for one year (which may not necessarily be your first year) if:

- Your accommodation application form reaches the Accommodation Services by 30 June in the year of application.
- Your home address is outside the M25 ring road.
- You accept our academic offer as your firm choice.

The majority of King's residences are in central London locations, and many are close to King's teaching campuses. All are within the London Travel Zones 1 and 2. Most of our residences are staffed by resident managers who are supported by a team of appointed senior students. King's residences range from:

- Halls of Residence – may be traditional, catered halls or with self-catering facilities.
- Apartments – self-catering for four to nine students, each room with en suite shower and toilet.
- A student house – located off-campus in buildings and houses of traditional design offering self-catering facilities. Places are usually available for mature students only. Liberty House offers single studios sharing recreation/laundry facilities.
- Intercollegiate accommodation, to which all full-time King's students may apply, comprises seven University of London residences, which offer a valuable opportunity to mix with students from other Colleges of the University. One residence is allocated for mature students only.

If you apply to King's and are offered a place on one of our programmes, you will be sent a brochure with full details of our accommodation. More information on accommodation can be found on our website at [www.kcl.ac.uk/ug/acom](http://www.kcl.ac.uk/ug/acom) or in the main undergraduate prospectus for King's College. Copies can be obtained from the Compass on 020 7848 7070 or [thecompass@kcl.ac.uk](mailto:thecompass@kcl.ac.uk)

## Student facilities

### Library and IT Services

King's Information Services & Systems provide an integrated library, IT and archive service to all staff and students, including:

- Access to a huge multi-disciplinary, multi-campus information resource base including special collections, over a million books and thousands of journals.
- Web pages providing on-campus and remote access to electronic information resources including library catalogues, bibliographic and full text databases, e-journals, e-books and subject gateways.
- A network of over 1,500 PC workstations offering printing services and data storage with access facilities
- Wireless capability at each main campus.

### Technology for learning

King's works on a continual basis to take advantage of new and emerging technologies to support flexible and innovative learning support. The Virtual Campus (VC) is an online environment providing a web-based interface for students to access resources for support of teaching and learning, including administrative systems and support services, no matter where they are based. The VC provides resources such as the interface for interactive online clinical scenarios, online timetables, lecture resources, course information, examination results, past papers and course feedback systems. Other developments being made include interactive tutorials, e-learning resources and a subject-specific Frequently Asked Question bank.

### Gordon Museum

The Gordon Museum is a truly unique resource with a wide-ranging collection of medical and dental instruments and artefacts, and a collection of around 8,000 pathological specimens. The Museum provides classic pathological specimens in all fields of Pathology from the 17th up to the 21st centuries as well as historic specimens such as those of Hodgkin, Addison, Bright, Astley Cooper and the forensic specimens of Keith Simpson. Also held are historic collections of anatomical, dermatological and pathological wax models, which are still used in modern teaching.

### Clinical skills

The Clinical Skills Centre aims to provide a non-threatening environment for learning and to make the transition to the clinical environment as smooth as possible.

The Clinical Skills area in Guy's Tower is state-of-the-art, and the largest facility of its type in the United Kingdom. There are 60 stations with direct video link to a central



teaching area. These stations comprise of fully equipped clinical areas with a mannequin head, complete with lips and teeth replacing the patient. In this facility students have a unique opportunity to simulate conditions encountered in the clinical area, providing them with a safe environment in which to develop their operative skills.

### Student welfare

The personal and academic welfare of our students is very important. Pastoral care is provided by a network of individual tutors and experienced advisors who give support, guidance and encouragement throughout the programme. Academic support is also provided for students. A full range of support services is provided within the College, including welfare and confidential counselling.

The Student Counselling Service offers counselling, whether specifically related to study or not, enabling students to make the most of the opportunities offered at King's by helping them to cope with any problems or difficulties of a personal or emotional nature. All help is offered strictly in confidence.

The Student Advice & International Support Service also supports students, offering free and confidential advice to both current and prospective students. They have expertise in a range of subjects, including money management, welfare benefits, housing rights, legal issues and many other practical matters.

To assist the specific needs of international students, King's has a dedicated international student adviser within the Student Advice team. International students can obtain expert advice and guidance on visa and immigration matters, finance, working in the UK and other key issues before arrival and throughout their studies.

### Other support services

King's offers a variety of additional support services to all of its students. This includes disability support, equality and diversity, health and dental services and religious provision. More information on these support services can be found in the main Undergraduate Prospectus which can be obtained by contacting The Compass on 020 7848 7070 or [thecompass@kcl.ac.uk](mailto:thecompass@kcl.ac.uk)

# Funding



## Student funding at King's

Funding your studies at university can seem a little daunting, but with help from our experienced staff, you can easily see what options are available to you. Both the Student Funding Office and the Student Advice and International Student Support Service at King's offer confidential advice to both prospective and current students covering issues such as tuition fees, living expenses, bursaries, scholarships, student loans and other financial help available at King's to assist you, and we would encourage you to contact our staff if you have any queries, before or during your studies.

**King's College London**  
**G.31 James Clerk Maxwell Building**  
**57 Waterloo Road**  
**London SE1 8WA**  
**Tel: 020 7848 4362/4363/4471/4472**  
**Email: [funding@kcl.ac.uk](mailto:funding@kcl.ac.uk)**  
**[www.kcl.ac.uk/funding](http://www.kcl.ac.uk/funding)**

## Home/EU students: changes to student finance for 2012 entry

King's along with all other English universities and colleges is working hard to respond to the government's reforms to student finance, which will affect degree students applying for 2012 entry. King's is keen to ensure that prospective students have adequate time to research and understand their options. We will continue to update the website as the full implications of the plans become clearer and decisions are made.

More information on the government's plans can be found on the web pages of the Department for Business, Innovation & Skills at [www.bis.gov.uk/studentfinance](http://www.bis.gov.uk/studentfinance) or [www.direct.gov.uk/studentfinance](http://www.direct.gov.uk/studentfinance). The new system will come into effect from September 2012.

At the time of going to press, the College's proposals had been submitted to the Office for Fair Access (OFFA) for approval by July 2011. Please check the website for up-to-date information.

### The main points of the new proposals are as follows:

- King's intends to set its tuition fees at £9,000 per year from 2012 onwards (increasing in line with inflation for subsequent years, and subject to approval).
- Eligible students will not have to pay up front for their tuition. Instead, the cost of tuition can be met by a student loan for fees, which students will only start to repay once they have left their course and are earning over £21,000. Repayments will be 9 per cent of income above £21,000, so the amount repaid each month will depend on earnings. Someone earning £21,500, for example – currently the salary of a newly-qualified teacher – would initially



make repayments of just £4 per month. All outstanding repayments will be written off after 30 years.

- Full-time students will be entitled to a non-repayable maintenance grant of up to £3,250 towards living costs such as food, accommodation and travel. If their household income is below £25,000 per annum they will be entitled to the full grant. Students from families with incomes up to £42,600 will be entitled to a partial grant.
- Loans for living costs are available for all eligible full-time students.
- Students from lower income families will be able to benefit from a new £150m National Scholarships Programme.

In its Access Agreement the College is proposing that its widening participation and fair access initiatives include both increased financial support and investment in academic innovation, outreach, partnership and retention.

In the first instance, the College will be reinvesting 30 per cent of the additional fee income towards its widening participation initiatives and financial support, with investment totalling over £6 million in 2012-13 rising to £8 million by 2014-15. It is anticipated that about a third of our home undergraduate students will receive some financial support towards fees or living costs.

## Fees for overseas full-time students for the academic year 2012-13

The fees for 2012-13 have yet to be agreed. For 2011-12 the fees are £16,801 for the first year and £31,164 for subsequent years. 2012-13 fees will be similar, but subject to review.



# When I'm not studying



Choosing King's means choosing a university where staff and students work hard to achieve and sustain high standards of academic excellence. But working hard isn't the only thing King's is good at: it's a friendly place with a great students' union and lots going on.

## Enjoying London

When you come to King's you become part of London, one of Europe's most vibrant cities for arts and entertainment. London life is full, colourful and varied and there is a wealth of world-famous cultural resources on your doorstep. Many of London's attractions are free, including most museums, art galleries, libraries, parks and street markets. Visits to the theatre, opera, cinema, concerts and sports matches need not be expensive as many venues offer tickets at reduced rates for students. The Royal Festival Hall, National Theatre, Globe Theatre and the Tate Modern gallery are all within walking distance of Guy's and St Thomas' Campuses. As King's is at the heart of London, it is close to the worlds of the arts, government, the law and many areas of professional life. The College regularly welcomes writers, politicians, artists and famous alumni to speak and perform at King's.

## King's social life, sports & facilities

Apart from what London can offer, students also benefit from an extensive range of facilities and activities across the King's campuses and within the wider University of London. All students are automatically members of the King's College London Students' Union (KCLSU). KCLSU offers a wide range of facilities across all of the hospital sites. Guy's Campus has recently been transformed with a £1 million redevelopment, enabling the Union to offer a high standard of services. There is a bar offering drinks and food throughout the day. A coffee lounge has been created with sofas, easy chairs, desks and tables – the perfect place to relax. There is satellite TV and informal computing facilities. Guy's Supplies, the Union shop, and a bookstore are also located here. KCLSU has popular bars, where regular entertainment nights are organised, and social space on the other hospital campuses. In addition, all dental students are members of the Dental Society, which organises a programme of lectures and social events each year. Students can join any number of musical, sporting, theatrical, religious or current affairs clubs and societies. For up to date information on clubs and societies, visit the KCLSU pages at [www.kclsu.org](http://www.kclsu.org)

There are also societies for international students such as the Chinese, Indian, Malaysian & Singapore and Russian Societies (to name a few) designed to encourage social and academic activities amongst these student communities. The annual RAG Week is one of the highlights of the year for students and raises significant amounts of money for

charitable causes – over £100,000 last year alone.

King's caters for all musical tastes and skills: from rock to choral. There are formal and not so formal groups, and if you want to watch KCLSU provides a venue for gigs, attracting many up-and-coming, and more established artists. The College Chapel Choir has 25 scholars drawn from across the College – nine choral scholarships are also available. The College orchestra welcomes suitably qualified instrumentalists and the Guy's, King's and St Thomas' Hospitals' Music Society is open to staff and students of the three hospital campuses. Other musical societies can be found on the KCLSU website at [www.kclsu.org](http://www.kclsu.org)

There are many sporting societies at King's from archery, to water polo, yoga to basketball. There are squash courts and a gym on both the Guy's Campus and the St Thomas' Campus and a swimming pool on the Guy's Campus. The sports ground at Dulwich is close to the King's Denmark Hill Campus, and there are other sports grounds at New Malden and Honor Oak Park in south London. Between them they provide facilities for hockey, rugby, football, cricket, tennis, netball and croquet. Sailing takes place at Chichester and there are excellent rowing facilities on the Tideway at Chiswick. All of King's students are also automatic members of the University of London Union (ULU) and can take advantage of its facilities and services.

## The KCL Dental Society

The Dental Society at King's College London is a student-run society to support all student activity, in particular the social aspects of being at university. Being in central London offers tremendous scope for social and academic development and the Dental Society organises many formal balls, events and lectures to ensure maximum opportunity for interaction with all years. Visit the KCL Dental Society website at [www.kcldentalsociety.co.uk](http://www.kcldentalsociety.co.uk)



# Graduation & beyond

King's students are among the most successful when it comes to securing jobs or graduating to further study. Its excellent reputation among employers, well respected alumni and highly efficient Careers Service ensures that King's graduates get the best start in their life after College.

## Careers in dentistry

A variety of career pathways are open to our new dental graduates. The final career for many graduates is general dental practice, although an increasing number aim to become consultants in the hospital dental service, senior clinical academics in a teaching hospital, or specialist practitioners. A number of graduates find their way into full-time clinical research.

International students applying for dentistry should be aware that they do not have an automatic right to employment in the United Kingdom on graduation. You are advised to seek advice from the immigration and visa authorities and the General Dental Council as to your eligibility to practise dentistry or undertake further clinical training in the UK on completion of the BDS programme. An increasing number of graduates are starting 'General Professional Training', which is a structured introduction to junior hospital posts and vocational training in general practice. The ambitious will then sit the appropriate examinations of the Royal College of Surgeons in order to be



Alumni profile	
<b>Full name:</b> Sami Stagnell	
<b>Age:</b> 25	
<b>Programme studied at King's:</b> Dental Surgery BDS	
<b>Year of graduation:</b> 2009	
<b>Current job title:</b> Senior House Officer in Oral and Maxillofacial Surgery/Research Fellow	
<b>Current employer:</b> Barts and the London, King's College London	
<p><i>'Having graduated in 2009, I left London for a short while to undertake vocational training (DF1) and to experience dentistry elsewhere in the UK. This was immensely enjoyable and a fantastic way to expand on what I'd learnt at dental school. Soon the lure of the big city drew me back and for the last twelve months I have been a Senior House Officer in Oral and Maxillofacial Surgery. During this time I have also been very fortunate to maintain a close tie with the Dental Institute, working at King's as a Research Fellow, with a particular interest in developing the College's eLearning provision. These jobs have allowed me to meet many wonderful and interesting people who I thoroughly enjoy working and socialising with.'</i></p>	

eligible for competitive entry to specialist training in a hospital specialty or a practice-based specialty. You may choose to pursue an academic career and undertake research, which will initially require studying for a PhD. Clinical academics have the challenge of achieving excellence in teaching, research and clinical practice.

Many newly qualified graduates will enter practice by way of a vocational training scheme. Trainees work in a general practice under supervision and have a day-release course of lectures and demonstrations building on the undergraduate course and giving instruction in all aspects of practice management. After this year successful trainees begin work as an associate in a practice, later starting or purchasing their own practice.

A further group of newly qualified graduates may enter the community dental service where the emphasis is on the prevention of dental problems in the community and looking after the priority groups – people with disabilities or medical problems as well as older people, pregnant women and young children.

After successfully completing the training and associated examinations, you could join specialist registers of the General Dental Council and, according to the specialty, may become a hospital consultant. Your degree prepares you for

change and it is very likely that changes in the provision of oral health care will occur over your working life.

A limited number of appointments exist with industrial companies, in Government service and in the Armed Forces. Cadetships for undergraduate students leading to commissions are available. There are many opportunities to pursue a career in dentistry working on a part-time basis. One area which has expanded greatly in recent years is the availability of master's programmes in most of the dental specialties. These will enable you to pursue particular interests and acquire greater expertise in a specific area of dentistry. A wide range of these programmes is offered by the King's College London Dental Institute.

## Graduate education at the Dental Institute

It may seem a little early to start thinking about life post qualification, but whatever career path you choose when you gain your dental degree it is almost certainly going to involve graduate study. Whatever form this takes, whether it is a taught master's programme or a research degree such as a PhD, you have an opportunity to continue your education at the Dental Institute; an establishment that is a leading international centre of excellence for teaching and research.



## Taught programmes

The Dental Institute offers a wide range of programmes at Diploma, MSc and MClinDent level, many of which are appropriate for specialist training. The majority of the programmes are delivered at the Guy's Campus, although some are taught at King's Denmark Hill Campus. As with the undergraduate programmes, clinical facilities are excellent as are the research laboratories for undertaking clinically related projects.

The Institute is also proud of its innovative flexible learning programmes. These are popular options that allow students to pursue equivalent master's programmes, but in their own local practice environment.

## Research degrees

Graduate research students at the Dental Institute can work on a wide variety of research topics, from aspects of clinical dentistry to projects in the basic sciences that underpin clinical practice. In each case students work with supervisors who are at the cutting edge of their field. Dental Institute graduate research students often go on to have careers in research.

Further details of the graduate opportunities available at the Dental Institute can be found on our online prospectus at [www.kcl.ac.uk/graduate](http://www.kcl.ac.uk/graduate)





*Studying dentistry at King's brings you the benefits of innovative curricula taught by internationally renowned staff at an institution that combines teaching and research at some of the country's most famous hospital campuses*

**Dean & Head of the Dental Institute**  
Professor Nairn H F Wilson CBE PhD MSc BDS FDS DRD FRC

**Director of Admissions**  
Dr Lyndon Cabot AKC EdD MA(Ed) MSc BDS FHEA

All correspondence regarding student admissions at any point of entry should be addressed to the:

Health Schools Admissions Office  
King's College London  
Hodgkin Building  
Guy's Campus  
London SE1 1UL

**Email:** ug-healthadmissions@kcl.ac.uk  
**Tel:** 020 7848 6512  
**Fax:** 020 7848 6510  
[www.kcl.ac.uk/ugp](http://www.kcl.ac.uk/ugp)

## Dental programmes

King's College London Dental Institute is committed to increasing the diversity of its entrants. There is only one BDS dental degree course but there are currently three entry routes to accommodate applicants with differing educational experiences and backgrounds, the greatest range of entry opportunities of any dental school in the United Kingdom. Each programme varies in length and entrance requirements. In addition to the traditional five-year programme (A205), the Dental Institute offers a four-year Graduate/Professional Entry Programme (A202) primarily for graduates with degree-level education in biomedical sciences or a related subject and, unique to King's College London, is the three-year programme (A204) for medical graduates who seek a career in maxillofacial surgery or oral medicine/pathology.

### Dentistry BDS

Dentistry is an important healthcare profession. Dentistry is focused on preventing, as well as diagnosing and treating, tooth and mouth problems. The dental profession offers an interesting and varied career – you could choose to work in general practice, specialise in a particular field of dentistry, work in the Armed Forces or go into community dentistry. You should enjoy working as part of a team; as a dentist you would be expected to work with other dentists, dental nurses, technologists, hygienists and therapists in the treatment of patients. Dentistry is a caring profession and as a dentist you may have to reassure nervous patients or treat small children so the ability to empathise, a calm, friendly manner and good communication skills are essential. Whichever field of dentistry you choose to work in, you will enjoy a demanding and rewarding career in a fascinating profession.

In the last (2008) Research Assessment Exercise the Dental Institute confirmed its position as the most influential centre of excellence in the UK for oral and dental research. The Dental Institute undergoes regular quality assurance review by the Quality Assurance Agency and the General Dental Council to ensure the fitness for purpose of all its programmes. As a dental student at King's you would be taught by internationally renowned staff at an institution that combines teaching and research at some of the country's most famous teaching hospitals: Guys, King's & St Thomas'. As part of a multi-faculty university, you would have the opportunity to mix academically and socially with students from other disciplines. You would also have the option of taking an intercalated degree to pursue subjects of your interest in greater depth. With a reputation for excellent teaching in a friendly environment you will find that the Dental Institute at King's is the first choice for hundreds of potential undergraduates every year.

### Dentistry Programme BDS (five years)

#### Entry requirements

**UCAS code:** A205

**Application to offer ratio:** 9:1

**Places:** 128

**Deadline:** 15 October 2011

**3 A levels and 1 AS level:** AAA/A – BBB/C (please see page 26 and the website for further details and grade boundaries)

**A/AS level compulsory subjects:** Chemistry and Biology, at least one at A-level, the other must be at AS-level. If A-level Maths is offered, Further Maths is acceptable at AS-level only.

**GCSE requirement:** at least grade B at English Language and Maths, if not offered at A/AS-level

**Access:** Specific one-year (full-time) 'Access to Medicine/Dentistry' programmes offered by a UK Further Education Institution, or one-year (full-time) science foundation programmes offered by a UK Higher Education Institution. Please note that you must have been out of education for five years prior to taking an access course to be eligible to apply to our programme.

**Scottish Highers & Advanced Highers:** AA at Advanced Highers and AAB at three further Highers. Chemistry and Biology required, one at Advanced level

**Irish Leaving Certificate:** A1 A1 A1 A2 A2 B1 at Higher level including A1 in Chemistry and Biology

**International Baccalaureate:** 38 including 6, 6, 6 at HL including Chemistry and Biology, at least one at HL. Please note GCSE requirements. If no GCSE (or equivalent), passes are required at SL in English and Maths if not offered at HL

**USA: Advanced placement tests (two semesters only)**

Four AP subjects with 5554 including Chemistry and Biology

**Aptitude test:** The UKCAT must be sat in the summer before the UCAS deadline. More details, including sample tests, can be found at [www.ukcat.ac.uk](http://www.ukcat.ac.uk). UKCAT results are valid for one year only.

**Professional requirements:** The initial and continued enrolment of all students is conditional upon full Enhanced Criminal Records Bureau Disclosure and Occupational Health Clearance.

*International Baccalaureate, Irish Leaving Certificate, Scottish Highers and international qualifications have equivalent grade boundaries. More information including requirements for 36 other countries can be found on our website*

[www.kcl.ac.uk/prospectus](http://www.kcl.ac.uk/prospectus)

# Dental programmes

## BDS curriculum

### The first year

After a one week introductory course to prepare you for study at University and on the Dentistry Programme in particular, the remainder of the year is spent studying biomedical sciences and topics relevant to the practice of dentistry. Much effort has been put into making this year absolutely relevant to dentistry. Basic topics such as molecular and cell biology, and basic human systems specific to dentistry, will be covered. Throughout the year a course on applied dental science will introduce you to the clinical aspects of dental studies and show the relevance of the basic sciences. This popular course will introduce you to all aspects of clinical dentistry.

### The second year

The second year concentrates on the introduction and development of basic dental clinical skills. A state-of-the-art clinical skills facility allows the learning of necessary skills in a safe and non-threatening environment. You will treat patients in the associated NHS trusts with minor gum problems in the first term and in the second term you will begin the restorative care of your own patients to whom you will offer dental care for your whole time at King's College London.

Linked to the practical clinical courses will be biomedical

science subjects such as anatomy of the head and neck, oral biology, and you will also develop an understanding of all aspects of the nervous system relevant to dentistry. During this year you will begin learning about all aspects of human disease and this strand of learning will continue for the remainder of your time on the dental programme. This will include topics such as pathology, microbiology and general medicine.

### The third year

In the third year you continue to learn about all aspects of human disease and this is a major subject area in the year. Another major subject area for this year is the replacement of missing teeth. You will learn how this can be done using fixed and removable prostheses. There is a technical component to these courses to ensure you understand how they are constructed and how to deal with problems associated with their fit and function. Much time each week is devoted to the clinical treatment of patients in restorative dentistry that will include specific teaching in conservative dentistry and prosthodontics. You will also begin to learn about and carry out the extraction of teeth and minor oral surgery.

This is a busy year in which you really begin to establish yourself as a dentist.

### The fourth year

In the fourth year of the programme you spend most of the week providing dental care for patients. You will continue to learn about and carry out more advanced procedures in restorative dentistry. During this year major courses in periodontology, child dental healthcare and orthodontics are provided to give you a strong foundation in the subjects. You will be introduced to the operative procedures in the provision of implant dentistry.

Time is also spent providing comprehensive care to adult patients. This will continue in Year 5. As you become more proficient at dentistry, patients will be treated under conscious sedation. Learning continues in the human disease strand of the curriculum and you are introduced to an ongoing course in oral disease that will incorporate pathology and medicine directly relevant to disease in and around the mouth. You will be able to treat many patients with more complex dental problems during this year, with specialist teachers on hand to guide you.

### The fifth year

The final year of the programme is very much a consolidation year of all you have learned up to this time. You will continue to provide comprehensive dental care for adult and child patients. A specific feature of this programme is the opportunity to work on a regular basis at purpose built clinics away from the main campus. At these you will work directly with a dental nurse and other dental care professionals, in particular dental hygienists and therapists, learning to work as a team leader in the provision of dental care for your patients.

There is an opportunity each week to spend some time learning about a chosen topic to allow you to develop knowledge of an area in even greater detail than covered in the normal programme. This could include any area in dentistry and there is also the opportunity to learn a new language through the Language Centre of King's College London. There is an elective period of study when you are given the chance to travel anywhere in the United Kingdom, or the world, to learn about how dental care is provided in that region. Limited funding is offered by the College to undertake this period of study away from London. The final year is designed to allow you to develop as a dentist and to ease your transition, upon qualification, into vocational training and general professional training. It also offers the opportunity to flavour the specialist areas of dentistry that may encourage you to specialise after general professional training.

## Student view

*'I'm enjoying life in London and I realise how lucky I am to be at King's, one of the leading dental institutes in the world. I have particularly enjoyed the early clinical exposure into a professional environment, with its huge patient base and many world-class teachers. The programme requires hard work and total commitment, but it still allows you to have fun. Through joining the Acapella music group All the King's Men, I've managed to meet a great cosmopolitan group of people doing a large variety of degrees. In just a short time, we have performed not only within the College, but also at intimate venues in Europe and at the Edinburgh Fringe Festival.'*

Tomos Lavery (pictured front middle right)  
Dentistry BDS



Basic structure of the standard five-year BDS programme		
BMS = Biomedical Sciences, ADS = Applied Dental Science		
Year 1	BMS: Molecular and cell biology and basic human systems specific to dentistry. Social and behavioural sciences.	ADS: Introducing clinical aspects of dental studies, including radiological sciences.
Year 2	BMS: Head and neck anatomy, oral biology and the nervous system. Human disease and pathology.	ADS: Clinical skills and adult patient care in periodontology and conservative dentistry.
Year 3	BMS: Human disease. Biomaterials.	ADS: Adult patient care (technical and clinical) in fixed and removable prosthodontics, minor oral surgery, and conservative dentistry. Dental radiology and dental material science.
Optional intercalated year		
Year 4	BMS: Diagnostic skills (oral medicine, oral pathology, oral radiology, oral surgery). Therapeutics, special care dentistry and radiology.	ADS: Complete denture prosthodontics and advanced restorative dentistry, periodontology, child dental health, and an introduction to implant dentistry. Community dental practice.
Year 5	BMS: Diagnostic skills.	ADS: A year of consolidation. Dental care for adult and child patients. Sedation and special care dentistry, and acute dental care. Community dental practice and dental public health. Outreach clinical practice. Opportunity to flavour specialist areas of dentistry.

## Intercalated degree

At the end of Year 3, you will have the opportunity to take an intercalated BSc degree which allows you to pursue the subjects of your choice in greater depth. The advantage of studying at a multi-faculty institution such as King's is that intercalated degrees can be taken in a wide variety of subjects. For example, you may wish to study clinically relevant subjects and related topics such as health services management or psychology as well as more traditional subjects, such as neuroscience and biochemistry. You can even include a foreign language.

# Dental programmes



## Dentistry Graduate/Professional Entry Programme BDS

This innovative entry route into dentistry is designed to enable graduates with honours degrees in biomedical related science subjects and healthcare professionals with a degree to study dentistry on a four-year BDS degree programme. Students admitted to this programme will be exempt from the first year of the standard five-year programme A205 on the basis of their previous studies.

### Structure of programme

The first year begins early for graduate entry students. In September 2012, you will undertake a three-week preparatory course in applied dental science to give you the dental knowledge and skills to enable you to study with the students who have completed Year 1 of the standard five-year BDS programme. Four-year graduate students are incorporated into the BDS2 year groups and take the same assessments and tests. As a graduate student you are given the opportunity throughout your first year to review topics studied in BDS1 such that by the end of your first year your skills and knowledge are exactly the same as any other dental student entering Year 3 of the standard programme. Please see the entry for the five-year BDS programme for more information on Year 2, 3 and 4 of the Dentistry Graduate/Professional Entry Programme (Year 3, 4 and 5 of the five-year BDS programme).

## Dentistry Graduate/Professional Entry Programme BDS (four years)

### Entry requirements

**UCAS code:** A202

**Application to offer ratio:** 9:1

**Places:** 30

**Deadline:** 15 October 2011

**Graduate applicants:** At least an upper second class undergraduate honours, or a lower second class undergraduate honours degree combined with a postgraduate masters degree with at least a merit.

**Compulsory subjects:** A biomedically-related degree or a health professional with a degree.

**Non-UK degrees:** Applications will be considered from non-UK graduates with the equivalent of the requirements for 'graduate applicants' listed above.

**Aptitude test:** The UKCAT must be sat in the summer before the UCAS deadline. More details, including sample tests, can be found at [www.ukcat.ac.uk](http://www.ukcat.ac.uk). UKCAT results are valid for one year only.

**Professional requirements:** The initial and continued enrolment of all students is conditional upon full Enhanced Criminal Records Bureau Disclosure and Occupational Health Clearance.

### Student view

*'After nearly six years as an officer in the British Army I decided to return to full-time education. Starting as a mature student was not nearly as daunting as I expected and*

*I have met a great many others who have also taken brave steps in changing their lives. I chose King's as it was the most prestigious dental school in the UK and had excellent learning facilities.'*

**Sally Dalton**

*Dentistry Graduate/Professional Entry Programme BDS*



## Dentistry Entry Programme for Medical Graduates BDS

This three-year dental degree programme is designed specifically for qualified doctors wishing to pursue a career in either oral and maxillo-facial surgery or oral medicine/pathology.

### Structure of programme

Students admitted to this programme will be exempt from the first two years of the standard five-year programme A205 on the basis of their previous studies. Students will undertake a three-week preparatory course in September 2012 before joining a heavily modified year three of the five-year BDS programme.

Examinations are held at the end of each year, and a percentage of the marks for each examination are derived from in-course assessment, which may take the form of essays, practical tests or project work.

For 2012 entry, the application deadline at King's for A204 is 15 January and not the usual 15 October dental programme deadline. Please note: applicants applying for 2012 (or deferred 2013) entry are not required to sit the UKCAT aptitude test prior to applying to the Dentistry Programme for Medical Graduates A204.

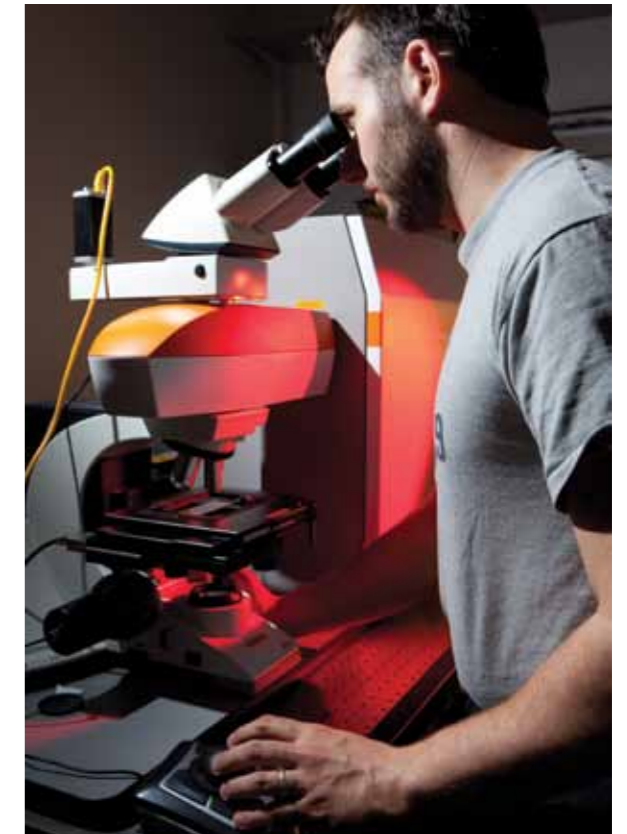

## Dentistry Programme for Medical Graduates BDS (three years)

### Entry requirements

**UCAS code:** A204

**Application to offer ratio:** 5:1

**Places:** 8

**Deadline:** 15 January 2012

**Entrance requirement:** Applicants must be qualified doctors, registered with the UK General Medical Council, and have completed Foundation Years 1 and 2.

**Other notes:** Applicants must wish to pursue a career in oral and maxillo-facial surgery or oral medicine/pathology

**Aptitude test:** None.

**Professional requirements:** The initial and continued enrolment of all students is conditional upon full Enhanced Criminal Records Bureau Disclosure and Occupational Health Clearance.

### Student view

*'Since I have been at King's, I have been impressed by its resources and levels of academic achievement and research.*

*I am privileged to be taught by people of such eminence in their fields and have been enveloped in the wealth of experience and ambition of my colleagues and teachers. As a mature student, I feel greatly supported by my tutors and faculty both academically and pastorally.'*

**Mehrnoosh Dastaran**

*Dentistry Entry Programme for Medical Graduates BDS*



# Selection procedure

Applications for A205 and A202 must reach UCAS by 15 October 2011. A maximum of four choices on the UCAS form may be made for courses which lead to a professional qualification in dentistry. A gap year is encouraged, but evidence of how that year will be spent should be included in your application. You may add an alternative non-health programme to your UCAS application. Please be assured that you will be considered as having a full commitment to dentistry whether you include non-health programme choices or not.

## The UKCAT aptitude test

Please note that all applicants applying in 2011 for 2012 (or deferred 2013) entry are required to sit the UKCAT aptitude test in the summer of 2011, prior to applying to the BDS degree. Please refer to the UKCAT website for details on registration at [www.ukcat.ac.uk](http://www.ukcat.ac.uk)

## Selection for interview

The Dental Institute aims to select the most able and appropriate students, not only in terms of academic ability, but also in relation to other interests and talents you may have which will contribute to the vitality of the Institute and College and with regard to your suitability as a future member of the dental profession. All UCAS applications received by 15 October are given equal consideration and scrutinised very carefully by the selection panels. Approximately 30 per cent of dental applicants are invited to interview after the initial consideration of UCAS forms.

## Academic achievement

You should carefully check that you will meet the Dental Institute's minimum academic standards before making an application. Please note that many applicants meet the minimum requirements and so all applications are considered within a competitive environment.

In line with the recommendations of the report Fair Admissions to Higher Education: Recommendations for Good Practice produced by the Admissions to Higher Education Review in 2004, King's will endeavour to consider other factors in addition to examination results, including the educational context of an applicant's formal achievement. As well as achievement at formal examination, King's will look for other indicators of potential and capability.

In line with these policies, our standard academic requirements for the five-year BDS will be AAA/A. We are keen to ensure we are selecting the very best students. Therefore, if you are performing exceptionally well within your peer group, and have achieved good scores in the UKCAT, we may consider predictions or achieved grades down to BBB/C.



## Personal statement and reference

Your personal statement is one of the many factors in the overall assessment of your application. We are looking particularly for evidence of appropriate commitment to, and realistic appreciation of, the academic, physical and emotional demands of a dental degree programme and career. We would normally expect that you will have undertaken some work experience in a caring environment and/ or observation in a dental clinical setting.

If this is not possible, we look for evidence that you have worked in a setting where you can interact with the general public, e.g. in a pharmacy or restaurant. Communication skills and the ability to work successfully in a team are of great importance. Your interests, achievements and contribution to your community are taken into account in addition to academic ability. We aim to ensure that all of our students can cope with the heavy academic workload of the programme and display those professional qualities, skills and attitudes that help to make competent and caring dentists. We would expect your application to be strongly supported by your referee both in terms of academic achievements/ potential and in terms of your character and suitability for dentistry.

Your UKCAT scores will be considered in our selection for interview. They will not be the sole indicator for selection, but will be balanced against achievement in other areas, in particular your academic performance to date. All indicators

will be considered together in deciding who will be selected for interview. It is therefore important to understand that there is no universal 'cut off' score for the UKCAT when applying for 2012 entry.

For example, if an applicant has an excellent academic background then the test scores will not play such a significant part in selection. For those with weaker academic backgrounds (relative to our overall applicant pool), the scores will become more important. An applicant who may not normally be considered on academic grounds could be invited to interview on the strength of strong UKCAT scores that may indicate potential. Also, if applicants are very similar in all other ways, the scores may be the determining factor in selection for interview.

## The interview

No offers are made without an interview. If you are selected for interview you will be sent information via myApplication.

The interview for A202 and A205 will follow the Multiple Mini Interview (MMI) system. Interviewees circulate from one timed station to another. At each station candidates meet one or two interviewers who ask structured questions and mark the responses to the questions independently. The MMI interviews will take place between December and

March and applicants should ensure they are free to attend an interview at this time, as alternative dates cannot always be offered. The aim of the interview is to assess your personal qualities and to find out whether you have the potential to become a successful member of the dental profession. In this context, strong interpersonal and communication skills are most important, particularly when you consider the relationships which dentists need to build with their patients. If you are made an offer for dentistry you will be invited to attend one of our post-offer open days.

For A204, conventional interviews are conducted by two senior clinical academics.

## Other information

In general applicants are sent an invitation to attend an interview two weeks before the date, by email and post. Included in the invitation pack are travel directions, a map and dress code. As we are seeking to identify your suitability for a clinical environment, we expect our interviewees to adopt the dress code required of clinical dental students at King's. All applicants who attend an interview will also be asked to sign a non-disclosure statement to try to ensure that all interviewees start with an equal knowledge about the interview process.



# General admissions information

## Decisions after interview

We aim to notify all interview attendees in writing of our decision within a fortnight of their interview. Applicants are ranked at interview and those who performed particularly well will be offered a place. Those who performed less well, but still to a high standard, are placed on a waiting list whilst all other interviews take place. At the end of the interview process in April those on the waiting list are compared with all other equally ranked interviewees, and all elements of their application are taken into consideration before a final decision is made.

Applicants who are interviewed for the GPEP programme will be informed of the result of the interview as soon as possible but this could be several weeks afterwards. This is particularly the case for those who receive middle ranking scores at interview. Performance at interview will determine whether a four or five-year offer is made. To fill 30 places, approximately 36 offers are made for GPEP, to the highest scoring interviewees. Further offers (usually another 20) are then made for the five-year programme. If these candidates accept this alternative offer, they act as a reserve if four-year GPEP places become available. If places do not become available, they enter the five-year programme in the normal way.

## Post-offer open days

If you are made an offer for one of our Dentistry programmes you will be invited to attend one of our post-offer open days. We encourage offer holders to take these opportunities to learn more about the programme and what it is like to study at King's. You will meet students as well as going on a tour of the Guy's Campus and accommodation.

## EU and international applicants

There is no quota on the number of EU students who may be admitted. For international applicants, the UK government places a restriction on the number of entrants.

## Graduate applicants to dentistry

We encourage graduate applicants to apply to study dentistry. Graduate applicants do not normally have to satisfy the usual A/AS-level or other entry requirements (e.g. you are not expected to have AAA at A-level at the first attempt). The minimum entry requirement is a pass at A/AS-level Chemistry and Biology plus an upper second class honours degree. Alternatively, a lower second class honours degree is acceptable combined with a master's degree (with at least a merit). For 2011 entry, approximately ten per cent of our five-year programme dental students were graduates.



## King's equal opportunities policy

King's College London is committed to promoting and developing equality of opportunity in all areas of its work. In order to achieve this aim, the College will seek to:

- Ensure that prospective and current students, job applicants and members of staff are treated solely on the basis of their merits, abilities and potential without any unjustified discrimination on grounds of age, sex, disability, family circumstances, race, colour, nationality, citizenship, ethnic origin, social and economic status, religious belief, sexual orientation, marital status or other irrelevant distinction.
- Promote good relations between individuals from different groups.
- Recognise and develop the diversity of skills and talent within both its current and potential staff and student body
- Foster a culture based on trust and mutual respect.
- Undertake a programme of action to make equality policies effective.
- Monitor progress towards achieving equality of opportunity on a regular basis.
- Communicate to staff, students, associates and others the promotion of equal opportunities and College procedures to sustain it.

## General admission policies

### English language requirements

To follow our programmes successfully, you must have a good command of English and be able to apply this in an academic environment. Therefore, you will usually be required to provide certificated proof of your competence in English before starting your studies. The requirement may be waived, but only if the College is satisfied that your previous academic record clearly demonstrates your ability to study and be examined in the English language. IELTS (7.0 overall with a minimum of at least 6.0 in all four skills), and English Language pre-sessional run by King's or one of the other tests listed on our website are usually acceptable. Please see [www.kcl.ac.uk/ug/apply/langreq.html](http://www.kcl.ac.uk/ug/apply/langreq.html) for more information.

More information on programmes run by King's College English Language Centre can be found at [www.kcl.ac.uk/elc](http://www.kcl.ac.uk/elc)

### Mature applicants

Applicants with significant life experience are valued for the experience and qualities which they bring to the School and College. You must satisfy the normal entry requirements. Please contact the undergraduate health admissions team for details on your individual circumstances and entry requirements.

## Unacceptable A-level subjects

Please note that in line with College policy neither A/AS-level General Studies nor Critical Thinking are accepted as one of your A or AS-levels.

## Re-sit applicants

Re-sit applicants are not considered except where there are extenuating circumstances. It is expected that all A/AS-level grades will be achieved within two years (eg during years 12 and 13). We are looking for applicants who can study and pass subjects to a high level over a specific time frame, as this will indicate that they are able to deal with the academic load of our dental programme. You may re-sit individual units within A/AS-levels as appropriate without prejudice to your application. If you are re-sitting the whole examination, or will be taking more than two years to complete the qualification, your application will be considered if extenuating circumstances, as judged by the Dental Institute, contributed to an unexpected poor academic performance at the first sitting.

## Offer holders meeting requirements and conditions

When your final results are known you will, of course, be accepted by King's if you reach the required grades. In a few cases, if you do not meet the academic requirements of our offer it may still be possible to confirm your place on the programme if you have accepted us as your Firm institution. This will depend on whether we have any spare places, and if we were particularly impressed with your application and interview. We will also look for evidence of high achievement in other examinations such as GCSE, AS-level and UKCAT and consider any mitigating circumstances such as illness in the period leading up to and during examinations. Your school or college will be required to confirm in writing that the relevant exam boards were not notified of your mitigating circumstances, and if not they must provide an explanation as to why. Any applicant offering a postgraduate master's degree or PhD must ensure that they will be able to satisfactorily complete their studies by August 2012. Conditional offer holders must supply to the College all complete examination results (including final grades) by 1 September 2012.

## Re-marked examinations

If a re-mark means that you achieve the grades for entry and you had previously have accepted an offer, then the place will be confirmed if documentation is available before 1 September 2012. If documentation is not available by then, a place will be reserved for you for the following year.



# General admissions information



## Applicants with disabilities/special needs

King's College London is keen to encourage applicants from all sections of the community, including those with disabilities/special needs so that the dental profession is diverse and representative. If you are thinking of applying for dentistry and you have a disability/special need, you are welcome to visit King's for an information visit before you apply. You can contact the Dental Institute Disability Advisor, the Health Schools Admissions Office or the College's Disability Support Team if you have any questions about studying at King's.

When applying to dentistry there are two reasons why it is important that you indicate any disability/special need on your UCAS application. Firstly, as the programmes lead to professional registration, in accordance with General Dental Council guidance, students with disabilities can be admitted provided their disability would not prevent them from completing all parts of the dental programme and thus restrict their dental practice to certain activities. The College therefore has a duty to ensure that only students who are 'fit to practise' their chosen career are admitted and graduate from the dental programmes. Also, any applicant who feels that he/she has a disability/special need which may compromise their fitness to practise has a responsibility to protect themselves and the patients with whom they will come into contact. When you tell us about a disability/special need, it will not be considered in the main selection procedure. If you are offered a place and accept it as your Firm choice you will be referred to Occupational Health who will make a formal assessment, as part of the normal Occupational Health appointment and clearance. Each offer holder is considered on an individual basis according to how the disability or health condition affects you. No general rules apply regarding particular conditions. The recommendations of Occupational Health will then be passed to the Dental Institute who will make a final decision. Once the requirement of 'fitness to practise' is dealt with, any details on your disability/special needs will assist the College in providing any support you may need during your programme and to make sure that anything required is in place at the start of the academic year. Any information you provide about a disability/special need will be processed sensitively and confidentially in accordance with the Data Protection Act.

## Health clearance

Any offer of a place at King's is subject to satisfactory health clearance coordinated by our Occupational Health Service. The reasons are:

- To ensure that you are medically 'fit to practise' for the proposed course of study.

- To advise, where necessary, on any reasonable adjustments, so that any underlying health problem is not made worse by work.
- To ensure that you do not have a medical condition which could pose a risk to your safety or to that of your colleagues, patients or members of the public.
- To help us identify if there is a risk of developing a work related illness from any hazards in the proposed workplace.

*Please note that occupational health appointments are compulsory for all firm offer holders between June and August.*

It is recommended that all students are appropriately protected against Chicken Pox, Measles, Mumps and Rubella (German measles), Meningitis C and Tuberculosis prior to enrolment. Also, the Department of Health has recently published new guidelines for healthcare workers. These guidelines recommend that all new healthcare workers involved in exposure prone procedures (EPPs) should be routinely tested for HIV Antibody, in addition to Hepatitis B Surface Antigen and Hepatitis C Antibody prior to receiving health clearance. Consequently, as well as needing to have blood tests for Hepatitis B Surface Antigen and Hepatitis C Antibody, as a prospective dental student, King's now require you to have a blood test to determine your HIV antibody status.

The final health clearance decision on your admission to, or continued enrolment on, the programme will be decided by the Dental Institute based upon recommendations from the Occupational Health Service.

## Criminal Records Bureau clearance

All offers of a place on a healthcare programme, and continued enrolment, are made subject to a satisfactory Criminal Records Bureau Enhanced Disclosure. All applicants are required to declare on their UCAS form if they have any spent or unspent convictions, cautions or reprimands. A copy of the King's College London policy for recruitment of students who are ex-offenders, use and storage of CRB Disclosure information or the CRB Code of Practice are available on request. Failure to complete the UCAS form correctly, or the disclosure process satisfactorily may result in exclusion, suspension or other disciplinary action.

## Contact details

### Dr Lyndon Cabot, Director of Admissions

Student Admission Office, Hodgkin Building, Guy's Campus London SE1 1UL. Tel 020 7848 6512, Fax 020 7848 6510, Email ug-healthadmissions@kcl.ac.uk

## Contacts

### Health Schools Admissions Office

Hodgkin Building  
Guy's Campus  
London SE1 1UL

Tel: 020 7848 6512 (*Dentistry*)

Tel: 020 7848 6511/6522

(*Biomedical & Health Sciences*)

Tel: 020 7848 6501/6502 (*Medicine*)

Fax: 020 7848 6510

Email: ug-healthadmissions@kcl.ac.uk

### Accommodation

#### College Accommodation Office

King's College London  
Strand Campus

Strand, London WC2R 2LS

Tel: 020 7848 2759

Fax: 020 7848 2724

[www.kcl.ac.uk/accomm](http://www.kcl.ac.uk/accomm)

### The Compass

*For the College prospectus*

Tel: 020 7848 7070

Email: thecompass@kcl.ac.uk

### English language courses

#### English Language Centre

King's College London

26-29 Drury Lane

London WC2B 5RL

Tel: 020 7848 1600

Fax: 020 7848 1601

Email: elc@kcl.ac.uk

[www.kcl.ac.uk/elc](http://www.kcl.ac.uk/elc)

### Equality & diversity

*For general advice for students with disabilities or specific learning disabilities*

#### Equality & Diversity Department

King's College London

7.36 James Clerk Maxwell Building

Waterloo Campus

57 Waterloo Road

London SE1 8WA

Fax: 020 7848 3490

*For appointments*

Tel: 020 7848 3398

Email: disability@kcl.ac.uk

[www.kcl.ac.uk/equal-opps](http://www.kcl.ac.uk/equal-opps)

### Finance & funding

*For advice on student loans and*

*hardship funds*

#### Student Funding Office

King's College London

G.31 James Clerk Maxwell Building

57 Waterloo Road

London SE1 8WA

Tel: 020 7848 4362/4363/4471/4472

Fax: 020 7848 4366

Email: funding@kcl.ac.uk

[www.kcl.ac.uk/funding](http://www.kcl.ac.uk/funding)

### Student advice & international student support

*For advice about finances, welfare benefits,*

*legal matters and immigration*

#### Student Advice & International

##### Student Support

Ground floor

King's College London

Henriette Raphael Building

Guy's Campus

London SE1 1UL

Tel: 020 7848 6858

Fax: 020 7848 6859

Email: advice@kcl.ac.uk

*(Open Monday, Tuesday, Wednesday and*

*Friday between 10.00 and 16.00)*

[www.kcl.ac.uk/advice](http://www.kcl.ac.uk/advice)

Admission to King's College London is subject to the requirement that you will comply with the College's enrolment procedure and will duly observe the Charter, Statutes, Ordinances and Regulations of the College and the University of London.

### Disclaimer

The following message contains some very important information. Please read it before you use this prospectus. This prospectus was printed in the summer of 2011. It contains information on the undergraduate programmes that King's College London intends to run for students who are planning to start university in the autumn of 2012.

The College has tried to give students an early opportunity to begin their research on universities and programmes. To do this, however, the information in this prospectus had to be collected and prepared 18 months before the start of the College's academic year beginning in September 2011. This means that some of it may become out of date or that details will have changed before the start of the academic year in which you will be beginning your studies.

The College has made every effort to ensure that the information provided is both helpful to prospective candidates and accurate at the time of its publication. Some circumstances (such as staff changes or resource limitations over which the College has no control) or the level of demand for a particular course or programme, or changes resulting from the new credit framework, may result in the College having to withdraw or change aspects of the programmes detailed in this prospectus. This could include, but not necessarily be limited to, programme/course content, staffing, the location where the programme/course is taught, and the facilities provided to deliver the programme.

Prospective candidates should note that, in the event of such circumstances occurring, the College cannot accept liability for any claims for costs or damages made by a student resulting from any change to, or withdrawal of, a programme/course that he/she had intended to study.

For this reason it is particularly important that you should check the website for updates ([www.kcl.ac.uk/ugp](http://www.kcl.ac.uk/ugp)) or contact the College using the contact details contained within this document.

King's has achieved a Bronze Athena SWAN Award for the work it is doing to promote the career progression of women working in science, engineering and technology areas.



Dental Institute at  
Guy's, King's College and  
St Thomas' Hospitals  
[www.kcl.ac.uk/dentistry](http://www.kcl.ac.uk/dentistry)

Design: Buchanan Davey

